

FRENCH CLEAT CAN BE
MOVED FROM HORIZONTAL TO
VERTICAL FOR VERTICAL HANG.

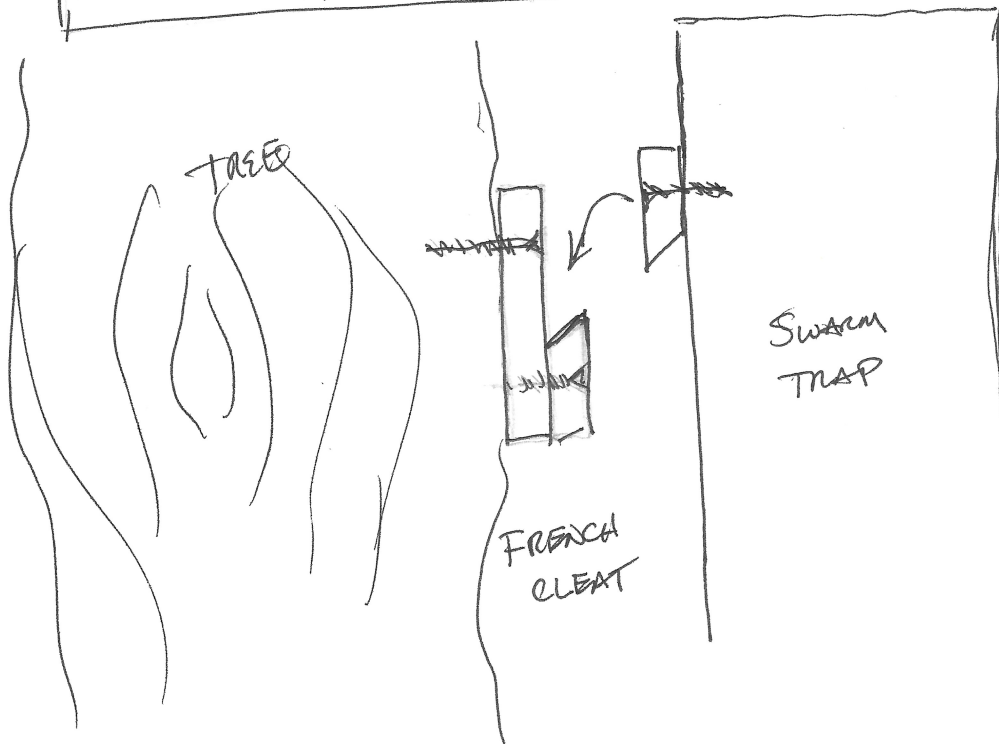
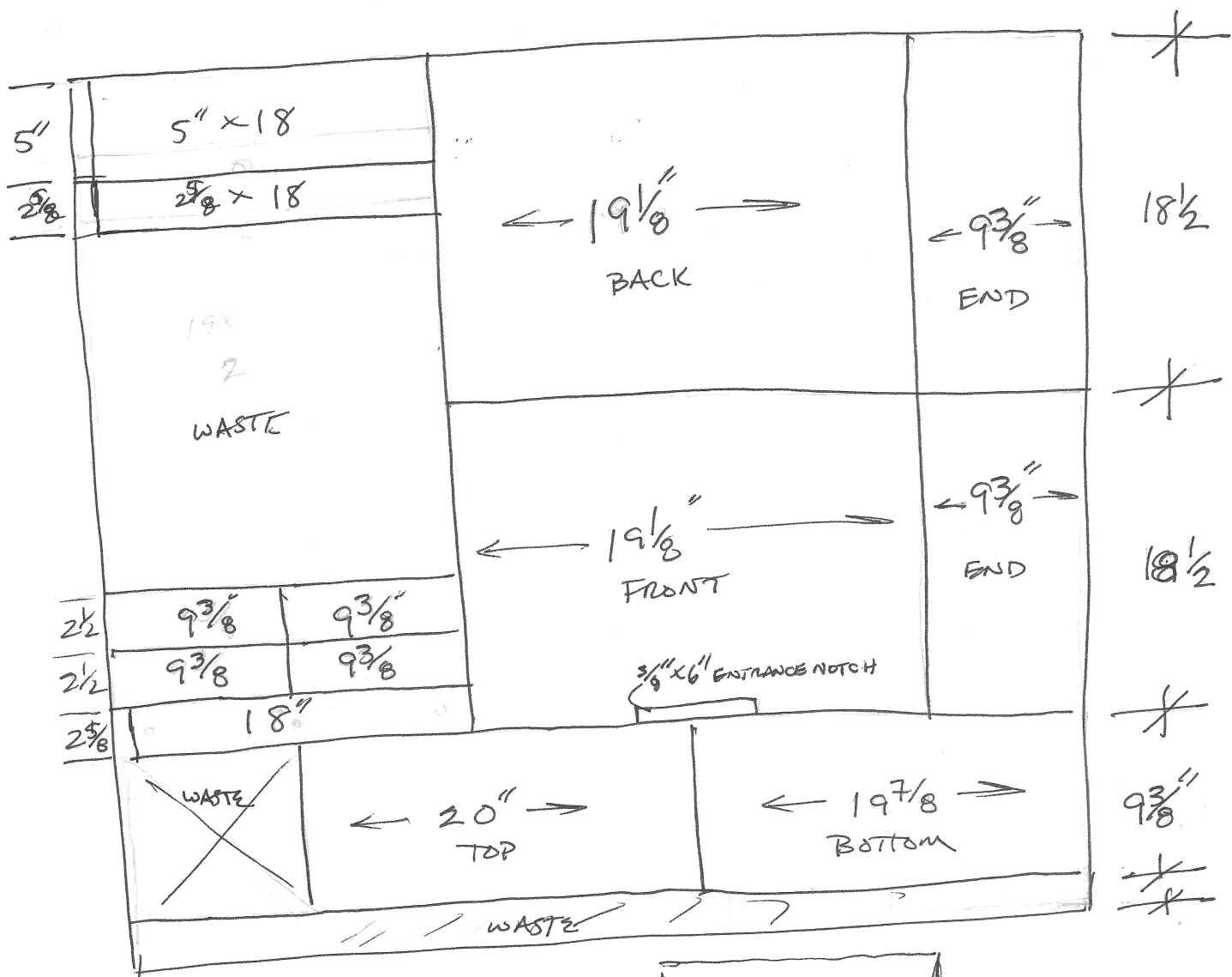

Homeless Honey Bee Shelter (48L.) Material cut list

All parts can be cut from 3/4" exterior grade plywood 48" x 48"

Description	quantity	thickness	x width	x length	Notes
Front & Back	2	3/4"	x 18-1/2"	x 19-1/8"	Cut 3/8" x 6" notch for entrance in 1 pc.
Ends	2	3/4"	x 18-1/2"	x 9-3/8"	3/8" x 3/4" rabbet (2) long edges & 1 short edge
Bottom	1	3/4"	x 9-3/8"	x 19-7/8"	
Top	1	3/4"	x 9-3/8"	x 20"	Note 1/8" longer than bottom
Cleats for top	4	3/4"	x 2-1/2"	x 9-3/8"	
Handles	2	3/4"	x 1-1/4"	x 9-3/8"	
Hanger /French Cleat	1	3/4"	x 2-5/8"	x 18"	Rip (1) long edge w/ 30* bevel
French Cleat @ tree	1	3/4"	x 2-5/8"	x 18"	Rip (1) long edge w/ 30* bevel
backer @ tree	1	3/4"	x 5"	x 18"	